

EVERLAST CLIMBING



**INSTALLATION INSTRUCTIONS FOR THE PLAYGROUND CLIMBING WALL 6' CLEAR
MODEL #WALL.PG.Clear 6'x12'**

(Please read all instructions thoroughly before beginning your installation)



EVERLAST CLIMBING



INSTALLATION INSTRUCTIONS FOR THE PLAYGROUND CLIMBING WALL 6' CLEAR MODEL #WALL.PG.Clear 6x12'

(Please read all instructions thoroughly before beginning your installation)

1. Start by laying your wall flat on the ground, as it would look once assembled. Outside posts are the Playground Single Posts and have only one channel running down the post. Place the rounded edges of the panels towards the tops of all the posts.
2. Drill holes in the panels through the holes in the posts. To allow for panel movement with temperature fluctuations, the holes must be larger than the bolts that secure the panels. Drill the holes $\frac{3}{8}$ ".
3. Using one person on either side of the wall, attach the panel to the channels with the (5) $\frac{1}{4}$ x 1" sex bolts, (5) $\frac{1}{4}$ " lock washers, and (10) $\frac{1}{4}$ " washers provided. The lock washer can go on either the bolt end or the barrel nut end of the sex bolt. Thread and "hand" tighten.
4. Repeat steps #2 & #3 until wall is completely assembled on the ground.
5. Mark the spots on the ground where the postholes will need to go based on the location of the steel posts.
6. Dig holes for the posts following the attached drawing. (That being 3' 6" deep and 16" in diameter.)
7. Now we need to suspend the panels 9" above ground level to leave room for the wood chips or other landing surface that will be installed. Place the posts into the holes, suspending the panels 9" from the ground. This can be accomplished by constructing a 9" base that the panels will rest on. This should place the posts into the ground 2' 3" and the panels 9" above ground level.
8. Stabilize the wall by staking the corners and tying string to keep it in a vertical position. Check to make sure it is level.
9. Pour concrete in all holes to the ground level.
10. Let the concrete set per the recommended manufacturers' instructions.
11. Remove all strings and stakes that were holding the wall vertical.
12. Place your Fill of either 12" of wood chips (compacts to 9") or 7" of shredded rubber.
13. Attach handholds with two people, one on each side of the panel. Put a $\frac{5}{16}$ " lock washer and a $\frac{3}{8}$ " washer onto a $\frac{5}{16}$ " x 2 $\frac{1}{2}$ " SHCS bolt. Push into handhold and through the holes in the panel. Put a $\frac{5}{16}$ " cap nut through a $\frac{7}{16}$ " washer (the M12 washer on your parts list) and push onto the handhold on the other side of the panel. Thread the handholds together and "hand" tighten.

EVERLAST CLIMBING

**INSTALLATION INSTRUCTIONS FOR THE PLAYGROUND CLIMBING WALL 6' Clear
MODEL #WALL.PG.Clear 6x12'**

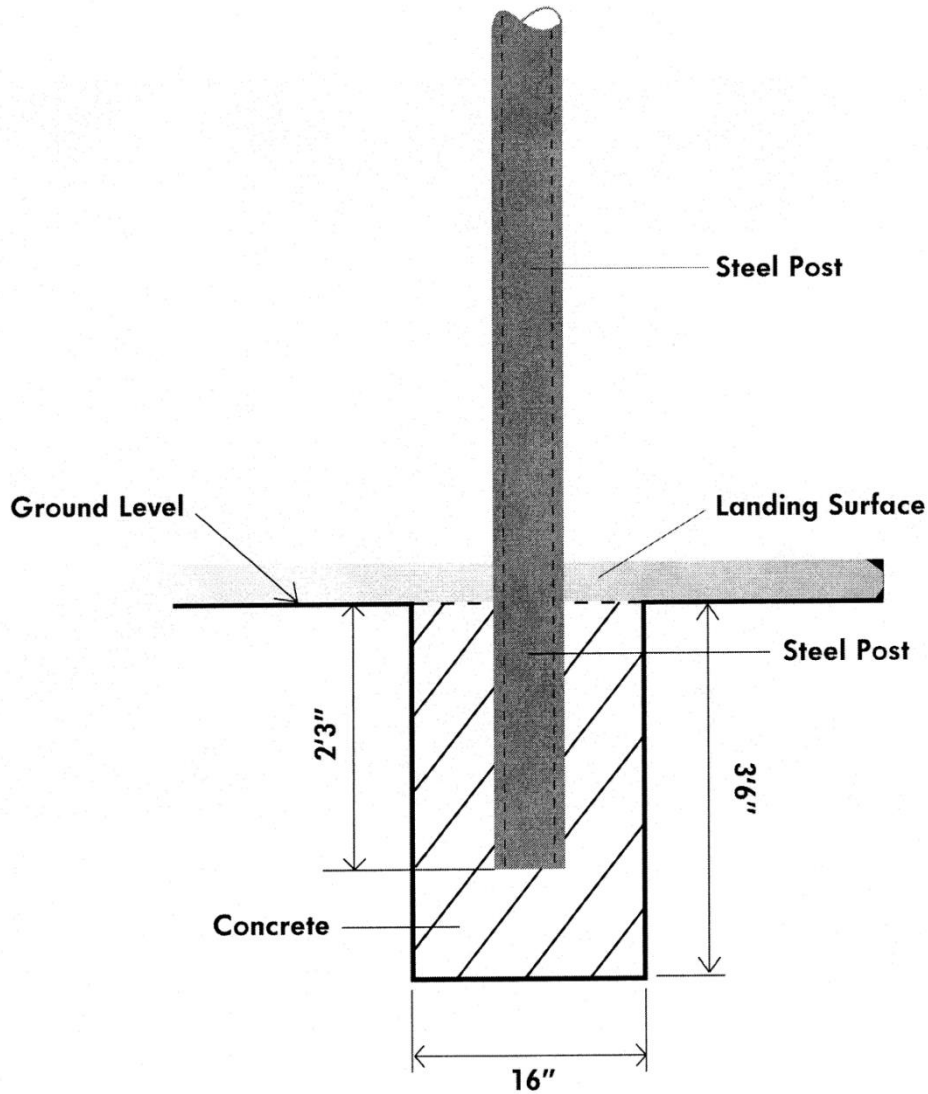

THE PROPER CARE AND ONGOING MAINTENANCE OF YOUR CLIMBING WALL IS
ESSENTIAL AND IS YOUR RESPONSIBILITY. PLEASE REFER
TO THE SAFETY, CARE Manufactured by Everlast Climbing / 800-476-7366 / Model
#WALL.PG.Clear 8x12' / dated. 07/16/2013 AND MAINTENANCE INSTRUCTIONS.

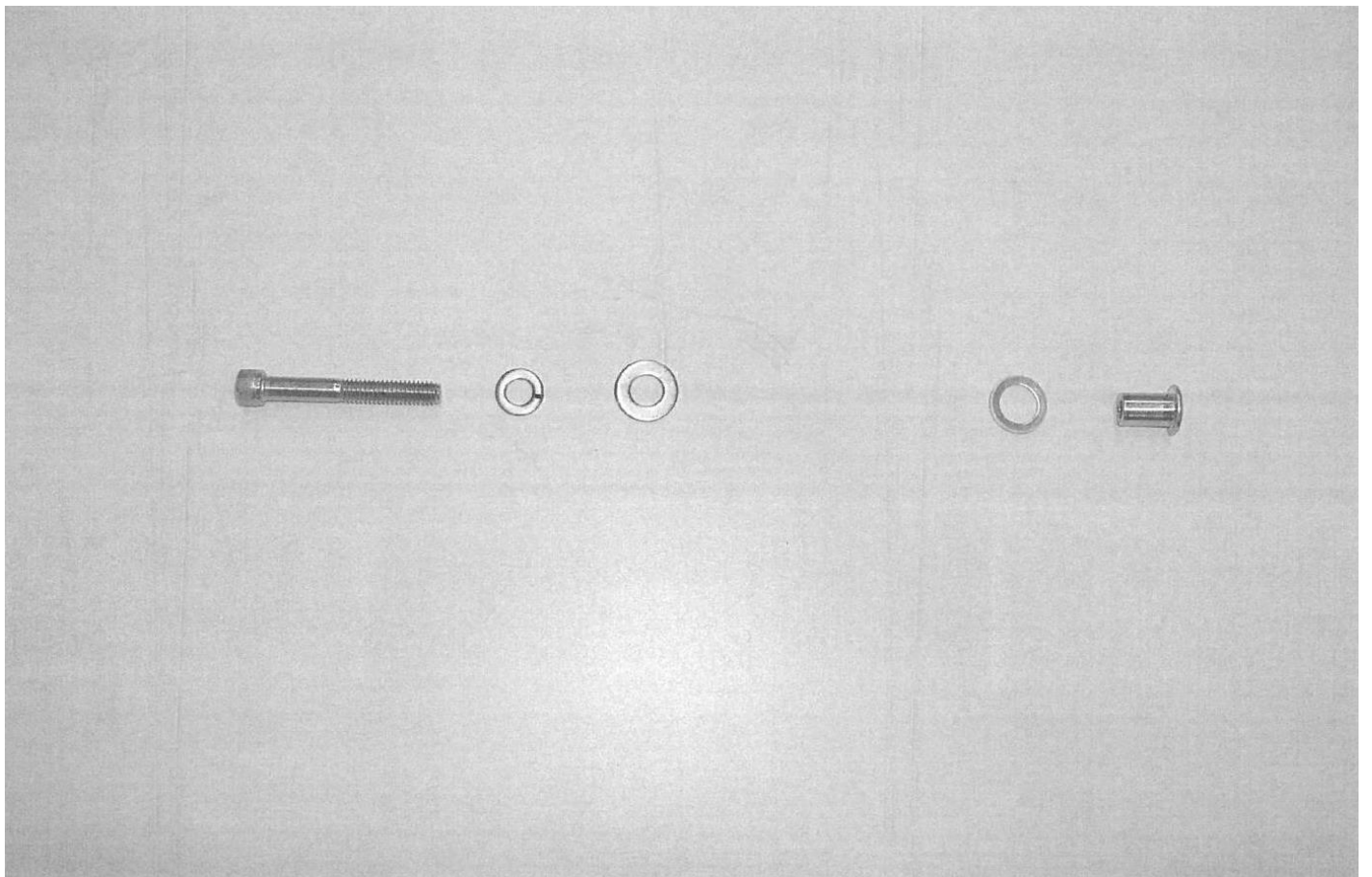

5/16" x 2 1/2" SHCS Bolt, 5/16" Lock Washer, 3/8" Washer, 7/16" Washer, 5/16" Cap nut

