

MBT-457 Trackride

Parts List		
DESCRIPTION	QTY	PART NUMBER
11'-0" METAL COLUMN - END DRILL 2H	4	M011B
TRACK RIDE BEAM	1	301399
TROLLEY HANDLE ASSEMBLY	1	301507
ATTACHMENT BRACKET	4	405556
CROSS BAR	2	405558
TRACK RIDE END PLATE	1	302674
COLUMN END FITTING	4	M600
END CAP	4	G010
----- HARDWARE COMPLETE -----	1	405559
12MM DO-NUT BASE	8	G034
12MM DO-NUT CAP	8	G036
3/8" LOCKWASHER	4	817334
3/8" BARREL NUT	4	804804
3/8" x 1 1/4" B.H.C.S.	4	811051
TROLLEY STOPPER	2	301318
3/8" x 3/8" SET SCREW	8	811549
1/2" THREADED INSERT	8	M000
1/2" INTERNAL TOOTH LOCK WASHER	8	817201
1/2" x 1 1/2" HEX HEAD BOLT	8	801205
#10 x 1/2" SHEET METAL SCREW	12	810062
1/4" x 15/32" DRIVE RIVET	8	805303
3/8" x 1" B.H.C.S.	3	811050

-Unless Otherwise Specified, All Units of Measure are Each

-Items listed below Hardware Complete line are included with Hardware Complete Number

Warning: During Installation, Hardware And Small Parts Are Choking Hazards For Young Children. Store Unused Parts Appropriately Until Assembly Is Completed. Once Assembly Is Completed, Remove Any Unused Parts From The Play Environment And Dispose/Save Them In A Secure Location.

Warning: Any bolt end protruding more than two full threads beyond the face of the nut causes risk of clothing entanglement. Promptly cut-off flush, file smooth, and treat to prevent corrosion.

Note: Peen Tee-Nuts and Flatwashers to match radius of pipe after assembly is complete.

Note: Loctite (supplied by others) should be used on any non-patch hardware.

MAINTENANCE PROCEDURE:

Regularly examine your playground structure and site. Maintain detailed installation, inspection, maintenance, and repair records for play equipment in each public-use playground area under your care. Check all play structure components for damage and wear. Check hardware for tightness, and tighten as necessary. Check metal parts for corrosion or paint loss, and apply touch-up paint if needed. Check welds for integrity and corrosion. Inspect resilient surfacing around equipment for correct condition and depth and remove any extraneous materials that could cause injury, infection, or disease. Immediately put impaired equipment out of service until any necessary repairs are completed.

MBT-457 Trackride

INSTALLATION INSTRUCTIONS:

1. Locate and dig footing holes. Refer to "Deep Column Footings" in the "Typical Column Footings" section of the Installation Prolog.
2. Attach Column End Fittings (M600) and End Caps (G010) to Columns (M011B) using Drive Rivets (805303) and Sheet Metal Screws (810062). See Typical End Cap Installation in the Installation Prolog.
3. Place Trolley Handle (301507) into TrackRide Beam (301399). Attach Crossbar (405558) thru Trolley Stopper and TrackRide Beam. See Detail 380.
4. Connect Attachment Brackets (405556) to the ends of the Crossbar (40555). See Detail 381.
5. Connect Attachment Brackets/Beam Assembly to Columns (M011B) using 1/2" Internal Tooth Washers (817201), 1/2" Hex Bolts (801206), Do-Nut Bases (G034) and Caps (G036). See Detail 383.
6. Connect opposite end of Track to other Column and Bracket Assembly, by repeating step 5. See Detail 383.
7. Attach Track Ride End Plate (302674) to open end of Beam. See Detail 382.
8. Plumb and level structure and pour concrete footings.
9. When the structure is finished and satisfactory, eliminate sharp points and sharp edges (burring) on installed hardware like bolts, nuts, etc. Install resilient surfacing material within the use zone of play structure in accordance with ASTM specifications F1292 appropriate for the fall height of each structure. Refer to the safety guidelines.

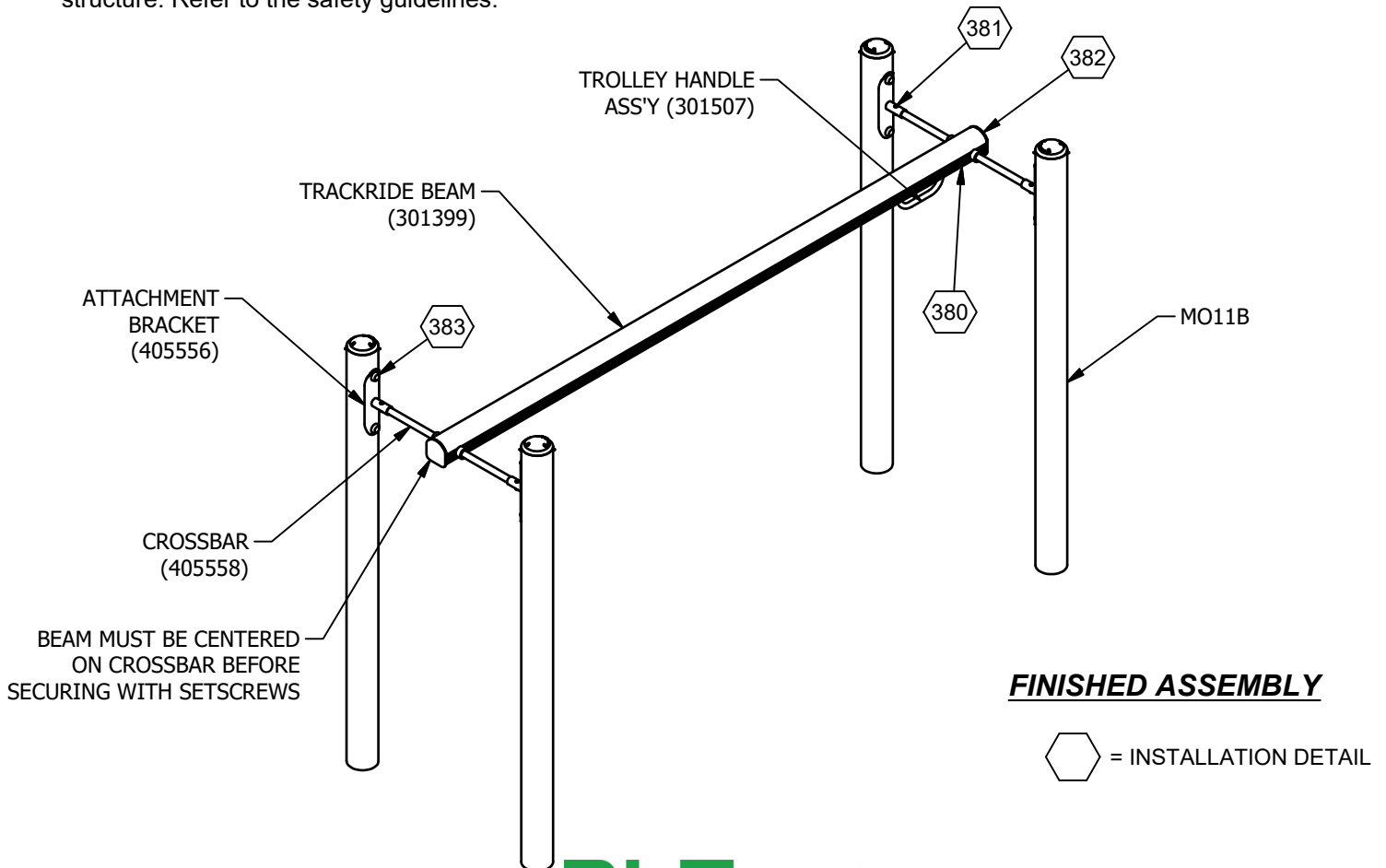

MBT-457 Trackride

PLAN VIEW

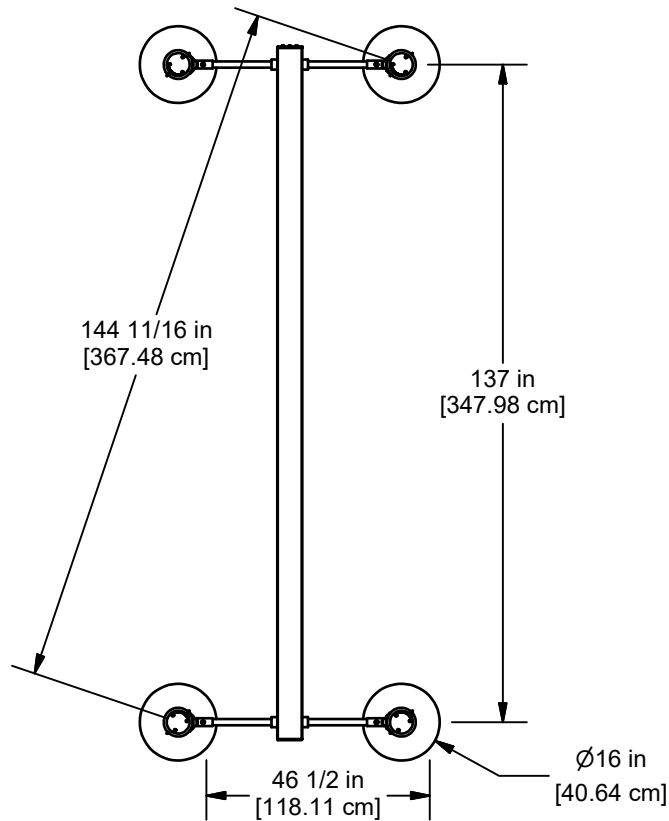

ELEVATION VIEW

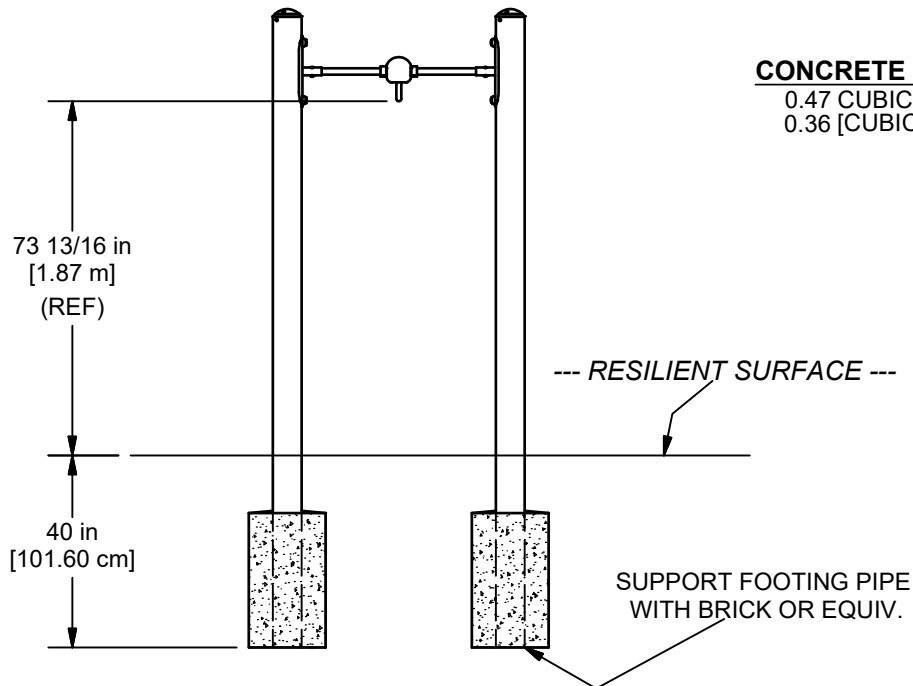

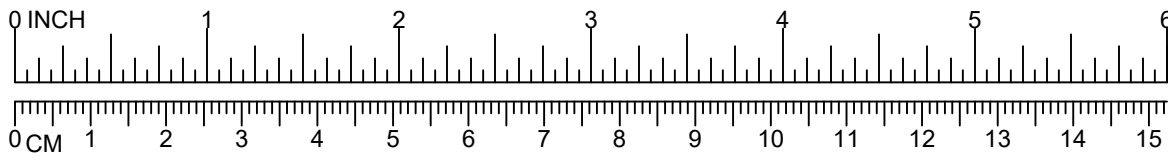

MBT-457 Trackride W/O Platforms

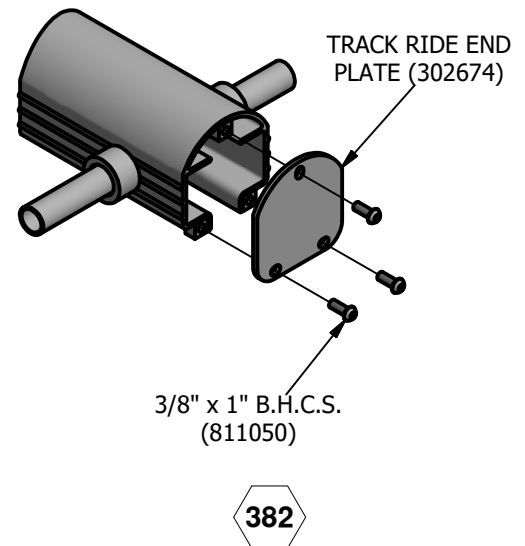
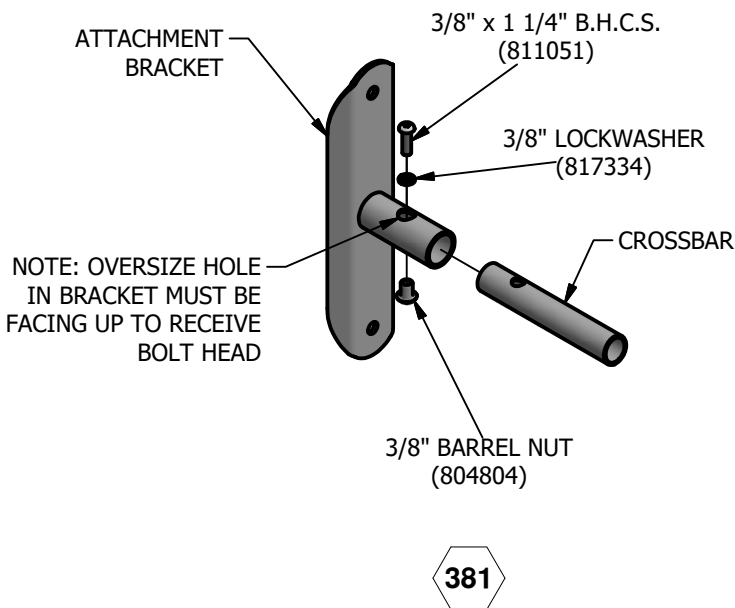
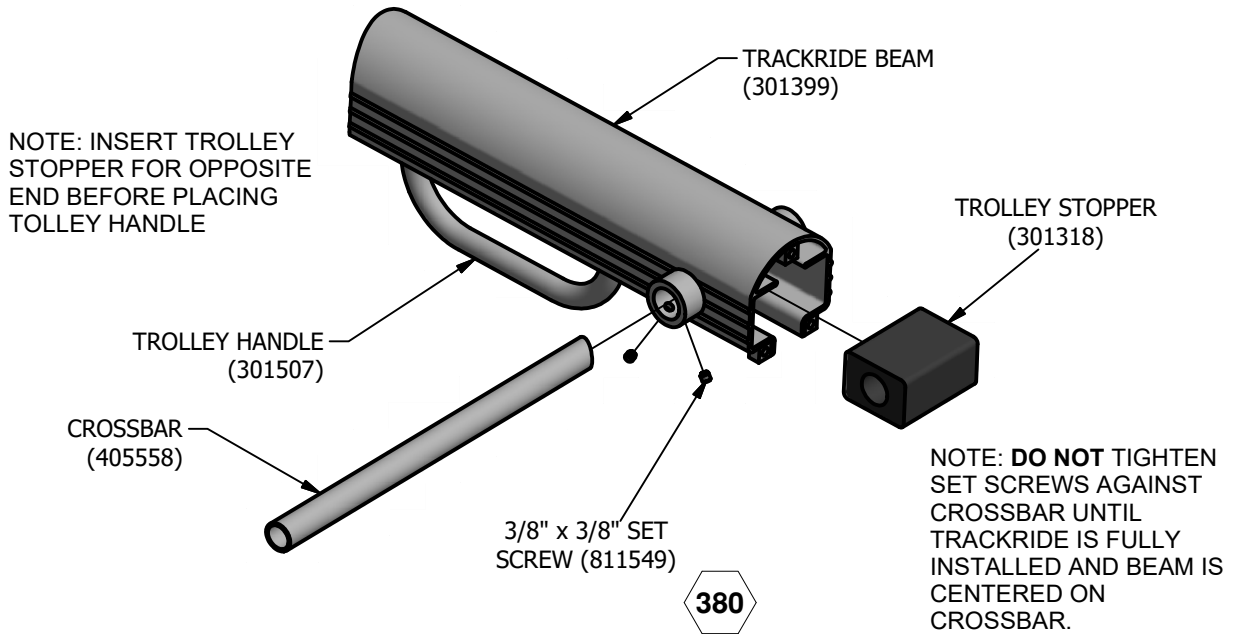

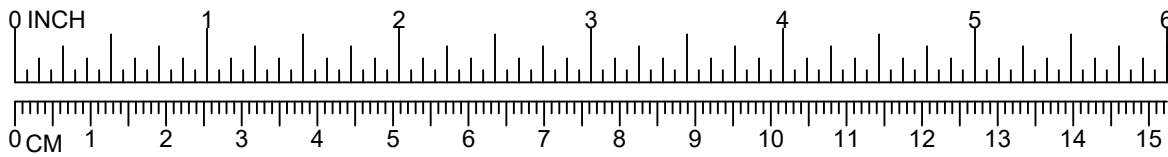

MBT-457 Trackride W/O Platforms

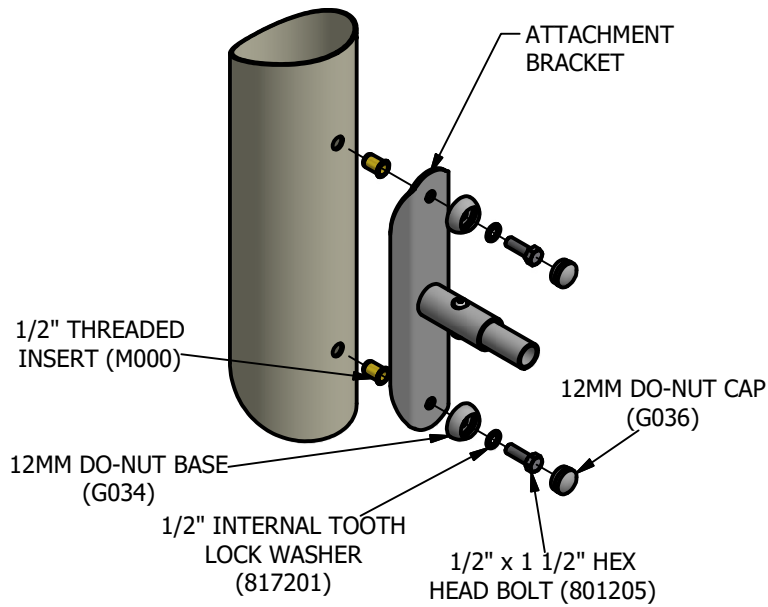

383