



MEC222 STANDARD GAS PUMP ON POST - METAL EC222 STANDARD GAS PUMP ON POST - WOOD

Parts List			
DESCRIPTION	MEC222	EC222	PART NUMBER
POST PUMP BACK	1	1	405102
PUMP RIGHT SIDE	1	1	405103
PUMP LEFT SIDE	1	1	405104
NOZZLE PANEL	1	1	405105
PUMP TOP	1	1	405106
PUMP FRONT TOP	1	1	405107
PUMP FRONT BOTTOM	1	1	405108
PUMP STAND	1	0	405109
PUMP BACK BRACE	2	1	405110
PUMP LONG BRACE	2	1	405111
PUMP MEDIUM BRACE	2	1	405112
PUMP SHORT BRACE	2	1	405113
PUMP TUBE	1	1	405114
WOOD PUMP STAND	0	1	405552
HARDWARE COMPLETE	1	1	405115
#4 x 1/2" PAN HEAD SCREW	1	1	809400
#10 x 1" WOOD SCREW	32	32	815515
#10 x 2" WOOD SCREW	7	7	815507
5/16" x 1" P.B.H.C.S. w/PATCH	1	1	812042
5/16" FLAT WASHER (5/8" O.D.)	2	2	817406
5/16" HEX NUT	1	1	804052

Unless Otherwise Specified, All Units of Measure are Each

Items listed below Hardware Complete line are included with Hardware Complete Number

Warning: During Installation, Hardware And Small Parts Are Choking Hazards For Young Children. Store Unused Parts Appropriately Until Assembly Is Completed. Once Assembly Is Completed, Remove Any Unused Parts From The Play Environment And Dispose/Save Them In A Secure Location. Any bolt end protruding more than two full threads beyond the face of the nut causes risk of clothing entanglement.

Promptly cut-off flush, file smooth, and treat to prevent corrosion.

Note: Peen Tee-Nuts and Flatwashers to match radius of pipe after assembly is complete.

Note: Loctite (supplied by others) should be used on any non-patch hardware.

SPECIFICATIONS:

Post Pump Back, Pump Right Side, Pump Left Side, Nozzle Panel, Pump Top, Pump Front Top, and Pump Front Bottom:

Shall be precision cut from a single solid sheet of .750" thick UV- stabilized high-density polyethylene with colors molded in. The material will have a density of 60lbs/ft³ and a tensile strength of 4400 PSI (30 Mpa) as determined per procedure C of ASTM D1928. All edges shall have radiuses and all corners for safe play.

Pump Stand:

Shall be fabricated from 4" x 4" Nominal HDPE UV-inhibited Plastic Lumber. Density/L.F.:0.061.

Wood Pump Stand:

Shall be fabricated from 4" x 4" Nominal Douglas Fir

Pump Back Brace, Pump Long Brace, Pump Medium Brace, and Pump Short Brace:

Shall be fabricated from 2" x 4" Nominal HPDE uv-inhibited Plastic Lumber. Density/L.F.:0.061.

MEC222 STANDARD GAS PUMP ON POST - METAL EC222 STANDARD GAS PUMP ON POST - WOOD

Pump Tube:

Shall be fabricated from .625" O.D. Black PVC Tubing.

Hardware:

All nuts, bolts, screws, inserts, and lockwashers used in the assembly of all play equipment, shall be stainless steel, yellow dichromate plated steel, blue-coated plated steel, mechanically galvanized or powder coated/yellow dichromate plated steel. All primary fasteners shall be 300 series stainless steel. Fasteners with yellow dichromate treatment have an electro deposited, 99.9% pure zinc substrate applied from a specially formulated solution sealed with a yellow dichromate top coat designed to work in conjunction with the zinc plating. Yellow dichromate has a 320% longer life to white corrosion and 275% longer to red corrosion than does hot-dip galvanizing. NOTE: All weights are based on average comparisons of each part.

INSTALLATION INSTRUCTIONS:

1. Dig holes according to the Ground Plan. See Ground Plan for dimensions and notes regarding surfacing, etc. **NOTE:** *Due to extremes in weather and soil conditions, hole sizes may have to be increased to meet local conditions.*
2. Attach Braces to Side Panels using #10 x 1 1/2" Wood Screws. See Detail 269.
3. Attach Post Pump Back to Pump Back Braces using #10 x 1 1/2" Wood Screws. See Detail 269.
4. Attach Pump Front Top and Pump Front Bottom to Pump Long Braces and Pump Medium Braces using #10 x 1 1/2" Wood Screws. See Detail 269.
5. Attach Pump Top to Pump Short Brace using #10 x 1 1/2" Wood Screws. See Detail 269.
6. Using 1/4" drill bit, drill hole in one end of the Pump Tube. Drill approximately 3/4" from end of Pump Tube.
7. Attach Pump Tube to the inside of the Pump Left Side using 5/16" x 1 P.B.H.C.S. w/Patch, 5/16" Flat Washer, and 5/16" Hex Nut. See Detail 267.
8. Attach Pump Tube to Nozzle Panel using #4 x 1/2" Pan Head Screw. See Detail 266.
9. Insert Nozzle Panel into Pump Left Side Panel.
10. Attach Pump Top to Pump Stand using #10 x 2" Wood Screw. See Detail 268.
11. Plumb and level the entire assembly and tighten all fasteners.
12. After entire unit is assembled, pour concrete footings within 4" to the top and taper away from post for water drainage. Allow to cure at least 48 hours before use. Temporary bracing may be required until concrete cures.
13. Check that all hardware connections are securely tightened. Smooth away any sharp edges that may have been created during handling and assembly. Install resilient surfacing within the use zone of play structure in accordance with ASTM specifications F1292, and appropriate for the fall height of each structure. Refer to all applicable safety guidelines.

MAINTENANCE PROCEDURE:

Periodically check hardware for tightness, and tighten as necessary. Always check all parts for breakage or wear, and immediately put equipment out of service until any faulty parts found are repaired or replaced. Also Check all metal parts for rust, paint loss and touch-up if necessary with paint. Check for welded areas and verify integrity. Check periodically resilient surfacing for appropriate depth and remove extraneous materials that could cause injury, infection, or disease. Maintain detailed installation, inspection, maintenance, and repair records for each public-use playground equipment.

MEC222 STANDARD GAS PUMP ON POST - METAL
EC222 STANDARD GAS PUMP ON POST - WOOD

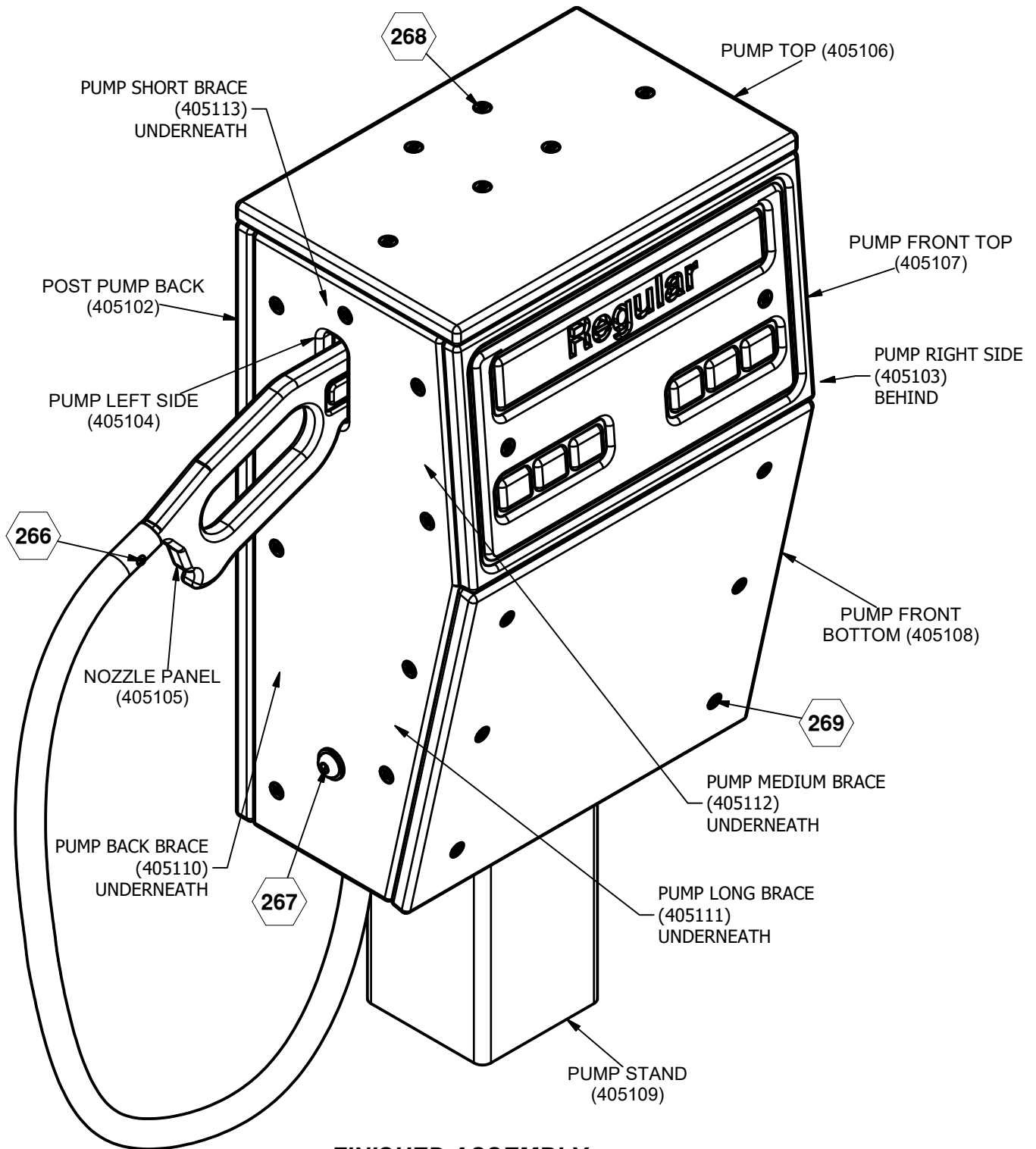

 = INSTALLATION DETAIL

FINISHED ASSEMBLY
MEC222 SHOWN

Issued/Revised: 8/30/2018

BigToys[®]

A PLAYCORE Company

SHEET 3 OF 6

1-866-814-8697

bigtoys.com

MEC222 STANDARD GAS PUMP ON POST - METAL
EC222 STANDARD GAS PUMP ON POST - WOOD

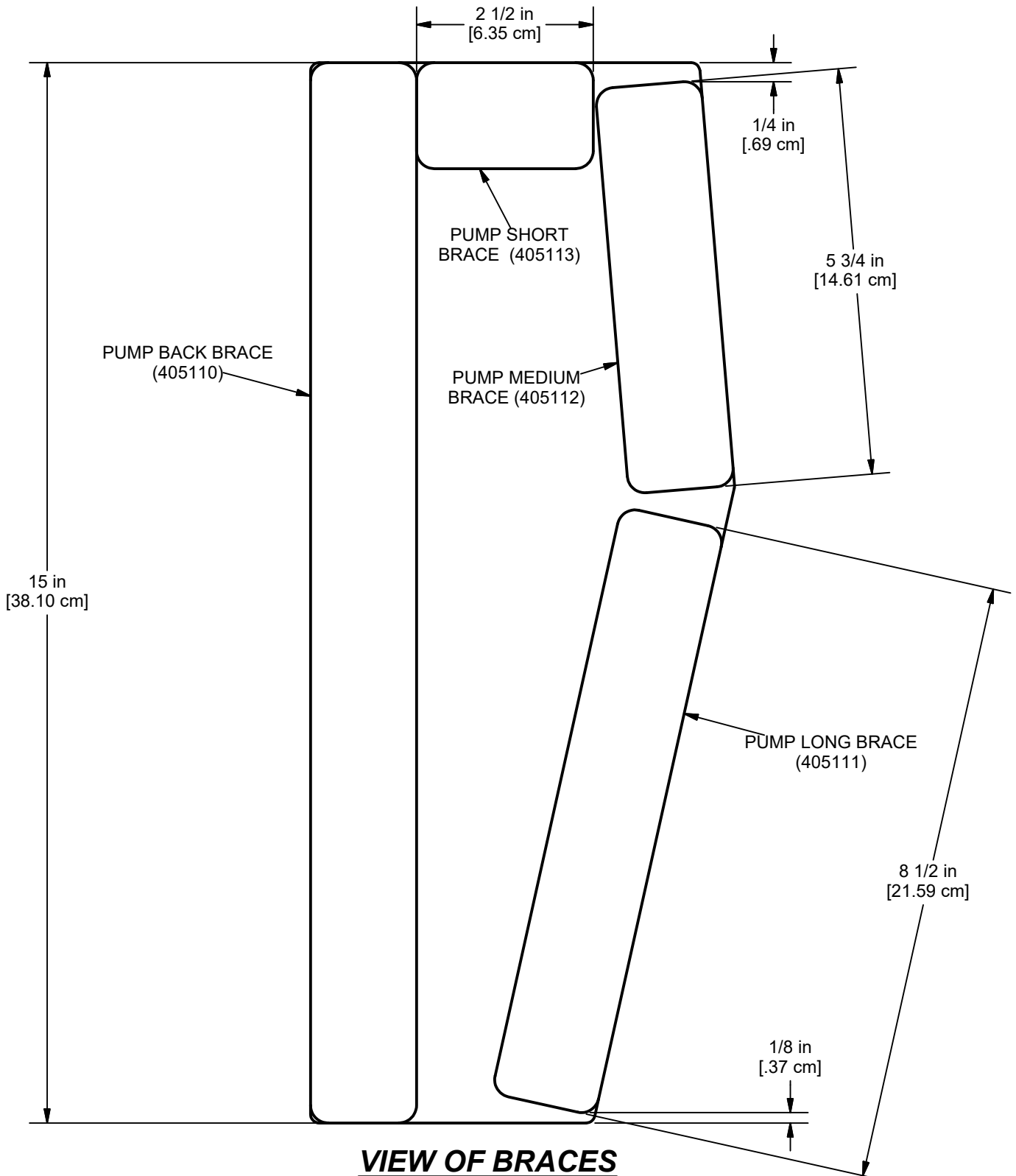

VIEW OF BRACES

MEC222 STANDARD GAS PUMP ON POST - METAL
EC222 STANDARD GAS PUMP ON POST - WOOD

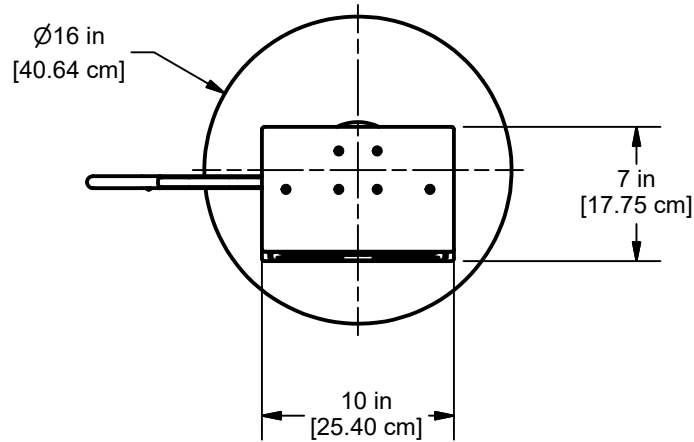

PLAN VIEW

CONCRETE REQUIRED
 0.052 CUBIC YARDS
 0.040 [CUBIC METERS]

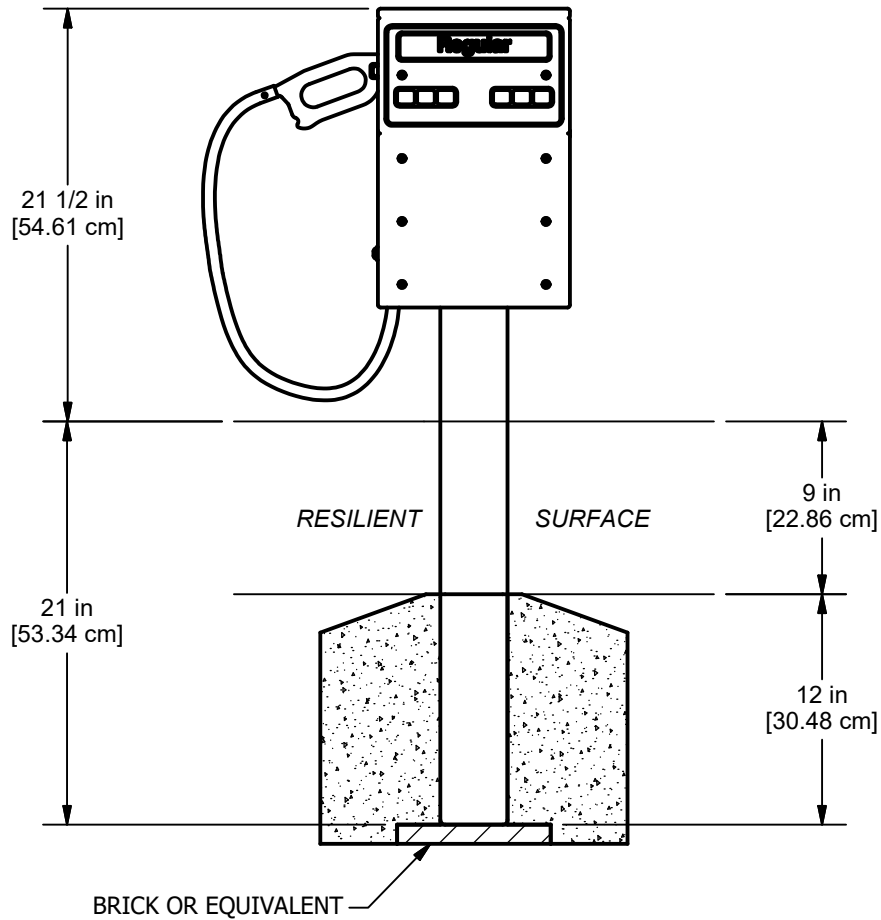

ELEVATION VIEW
 MEC222 SHOWN

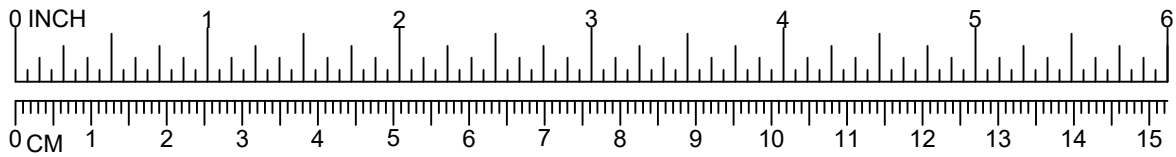

MEC222 STANDARD GAS PUMP ON POST - METAL EC222 STANDARD GAS PUMP ON POST - WOOD

266

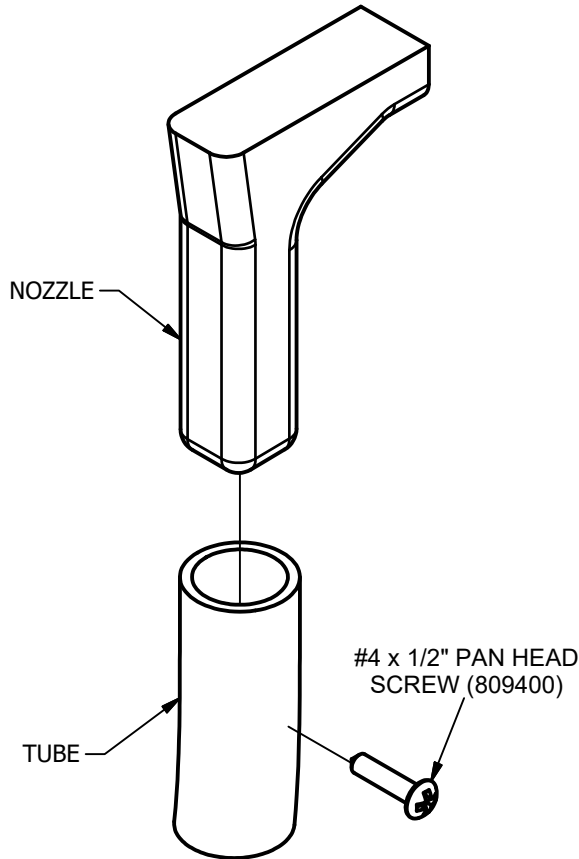

267

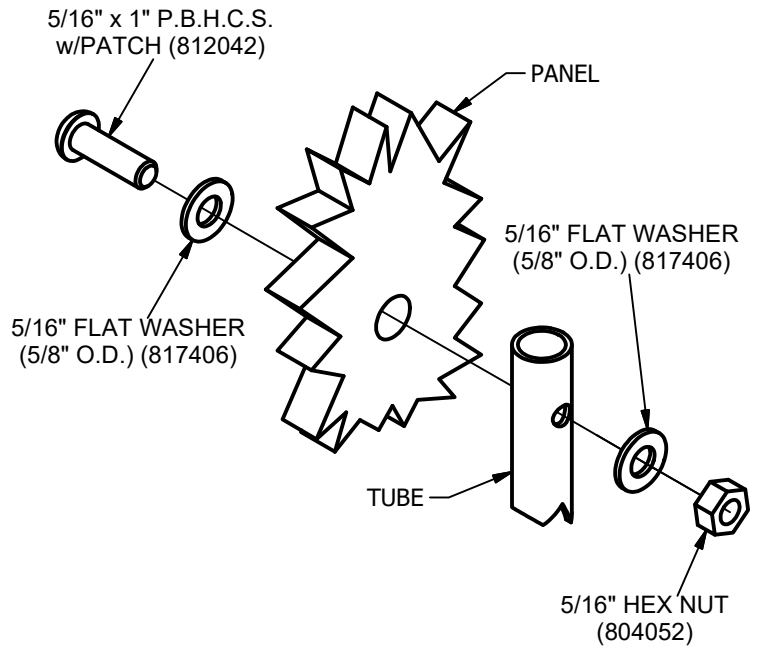

268

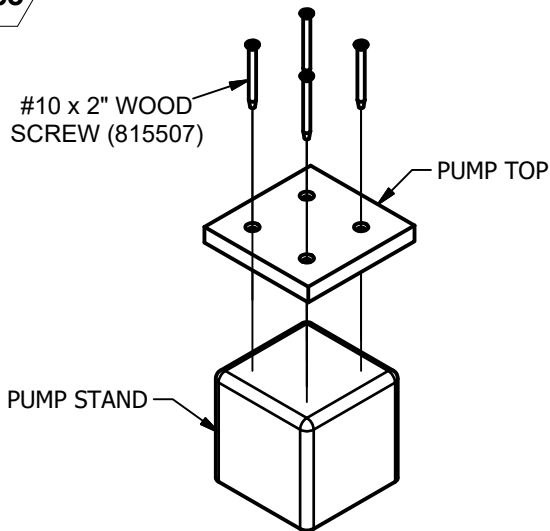

269

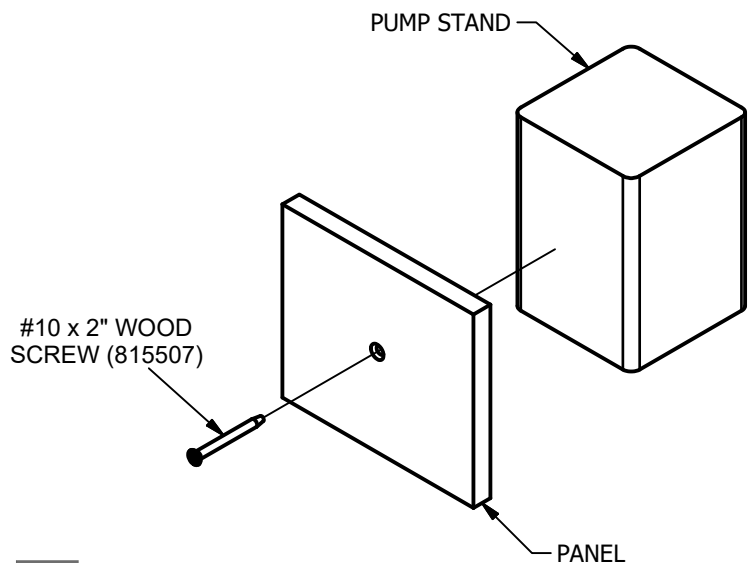

Issued/Revised: 8/30/2018

BigToys®

A PLAYCORE Company

SHEET 6 OF 6

1-866-814-8697

bigtoys.com