

Sea Horse Spring Rider

MEC-129
Installation Instructions



Parts List		
DESCRIPTION	QTY	PART NUMBER
BASE PLATE	1	304020
CENTER BODY PANEL	1	304672**
OUTER PANEL	2	304673**
FILLER PANEL	2	304674**
SEAT PANEL	1	304675**
COIL SPRING	1	304028**
BOUNCER BRACKET w/TAB & SLOTS	1	301101
BOUNCER BRACKET w/TAB & SQ HOLES	1	301096
HANDLE	2	304022
CAST ALUMINUM DISC	2	304026
<i>HARDWARE COMPLETE</i>	1	304068
FOOT REST	2	304024
1/2" x 2 1/2" CARRIAGE BOLT	4	800359*
1/2" FLAT WASHER	8	817412*
1/2" ANCHOR BOLT	4	800000*
1/2" LOCKNUT	8	804355*
3/8" x 2" THREADED ROD	1	803560*
3/8" BARREL NUT	5	804804*
3/8" ACORN NUT	2	804002*
3/8" FLAT WASHER	15	817410*
3/8" x 1 1/2" P.B.H.C.S. w/ PATCH	1	812053*
3/8" x 1 1/4" P.B.H.C.S. w/PATCH	2	812051*
3/8" x 2" P.B.H.C.S. w/PATCH	2	812055*
3/8" x 2 1/4" P.B.H.C.S. w/PATCH	3	812056*
3/8" x 1" P.B.H.C.S. w/PATCH	2	812050*
3/8" x 5" HEX HEAD BOLT	2	801019*
3/8" LOCK NUT	3	804353*
PLASTIC CAP	2	304074*
WHITE PLASTIC CAP	4	304072*
WHITE PLASTIC WASHER	6	304071*
3/8" LOCKWASHER	9	817334*

Unless Otherwise Specified, All Units of Measure are Each

** Included in Hardware*

***Included in Sea Horse Bouncer Kit #304671*

Warning: During Installation, Hardware And Small Parts Are Choking Hazards For Young Children. Store Unused Parts Appropriately Until Assembly Is Completed. Once Assembly Is Completed, Remove Any Unused Parts From The Play Environment And Dispose/Save Them In A Secure Location.

Note: Peen Tee-Nuts and Flatwashers to match radius of pipe after assembly is complete.

SPECIFICATIONS:

Panels: High-density .750" thick extruded solid polyethylene with color molded in and UV-stabilized.

Handles: Bent from 1 1/16" Galvanized Pipe, powder-coated after fabrication.

Spring: Free height 13-1/2", 5.75" O.D. steel tempered, powder-coated black.

Bolt Caps: Injection molded polypropylene, UV-stabilized, white and black in color.

Brackets: Formed from 3/16" steel, powder-coated black after fabrication.

Hardware: Primary Hardware is Stainless steel.

Weight: 82 lbs. / 37.3 Kg. Minimum Area Required: 15' 2" diameter [4623mm]

INSTALLATION INSTRUCTIONS:

IMPORTANT: Read through all instruction steps before starting. Apply a few drops of "loctite" Thread-locking compound to all carriage or hex bolt threads to resist loosening from vibrations. Do not attach Plastic Caps onto Plastic Washers until all assembly is completed and satisfactory. Do not fully tighten fasteners until ready to snap on plastic caps).

1. Dig footing as shown in Footing Detail.
2. Use the spring base plate as a template to make a plywood template for the placement of anchor bolts (plywood not supplied).
3. Attach 1/2" anchor bolts with washers and nuts to holes in template, allowing 7/8" of thread to protrude from concrete.
4. Pour concrete footing and lay template on surface in a level position. Force anchor bolts into concrete, allowing 72 hours curing time before removing template.
5. Attach Foot Rests to the Center Body Panel using Detail "A".
6. Attach Outer Panels to the Center Body Panels using Detail "B".
7. Attach Bouncer Brackets to the top end of the Coil Spring using Detail "C". Note: Cast Disc must be rotated to its maximum position towards the end of the spring and seated snugly.
8. Attach the Body/Outer Panel assembly along with the Filler Panels to the Bouncer Bracket as shown in Detail "D". Note: DO NOT install plastic caps into washers until entire assembly is complete and all hardware has been tightened.
9. Attach Handles to the Body Panel as shown in Details "E" and "F".
10. Attach the Eye to the Body Panel using Detail "G"
11. Attach Seat Panel to the Bouncer Brackets using Detail "H".
12. Attach lower end of the Coil Spring to the Base plate and attach to the J-Bolts as shown in Detail "I".
13. Install resilient surfacing material within the use zone of play structure in accordance with ASTM specifications F1292 appropriate for the fall height of each structure. Refer to the Safety Guidelines.

MAINTENANCE PROCEDURE:

Periodically check hardware for tightness, and tighten as necessary. Always check all parts for breakage or wear, and immediately put equipment out of service until any faulty parts found are repaired or replaced. Check for rust or paint loss and touch-up if necessary with paint. Check welded areas and verify integrity. Check for cracks, gouges or breakage on plastic, check for integrity of plastic, keep plastic clean of any extraneous substances, verify that any deformation does not create entrapment as specified on ASTM F1487 section 6. Check periodically resilient surfacing for appropriate depth and remove extraneous materials that could cause injury, infection, or disease. Maintain detailed installation, inspection, maintenance, and repair records for each public-use playground equipment.

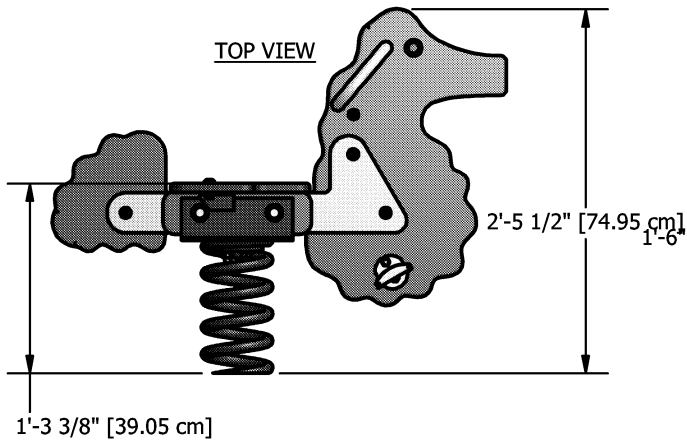
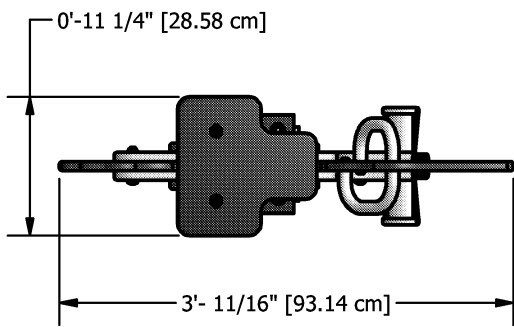
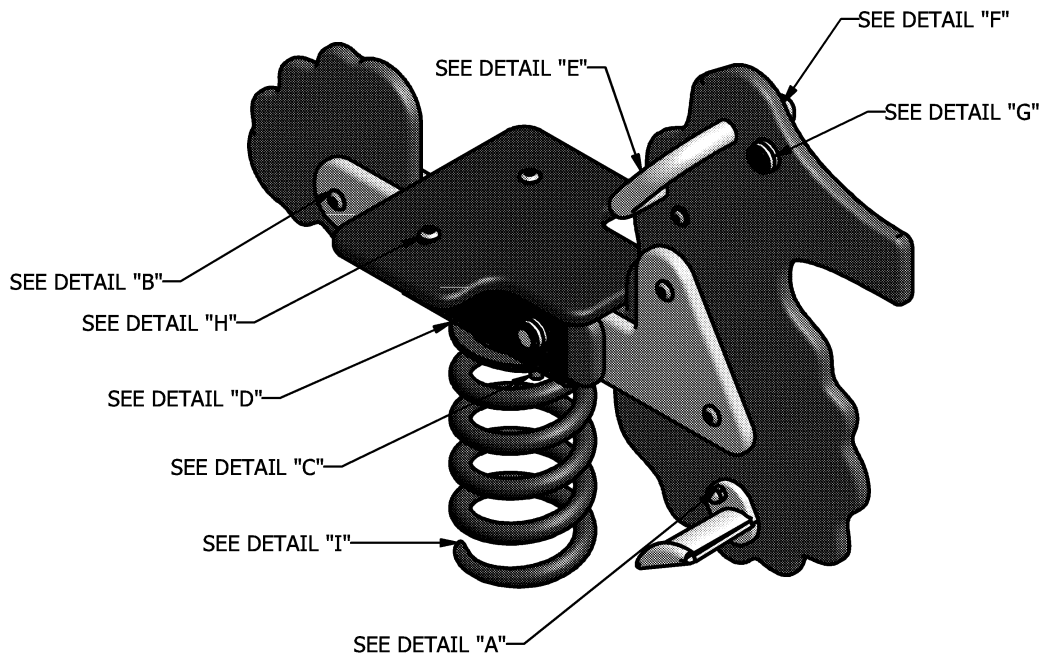

DIMENSIONS SHOWN IS WITH 3" OF SURFACING.

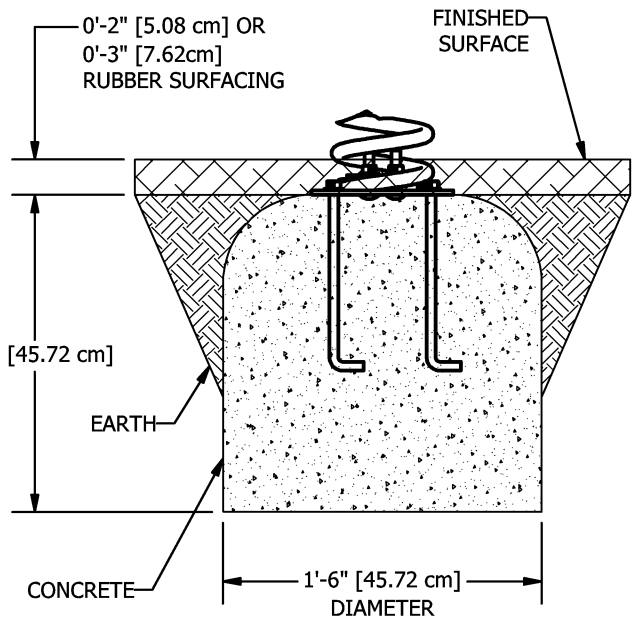

FOOTING DETAIL

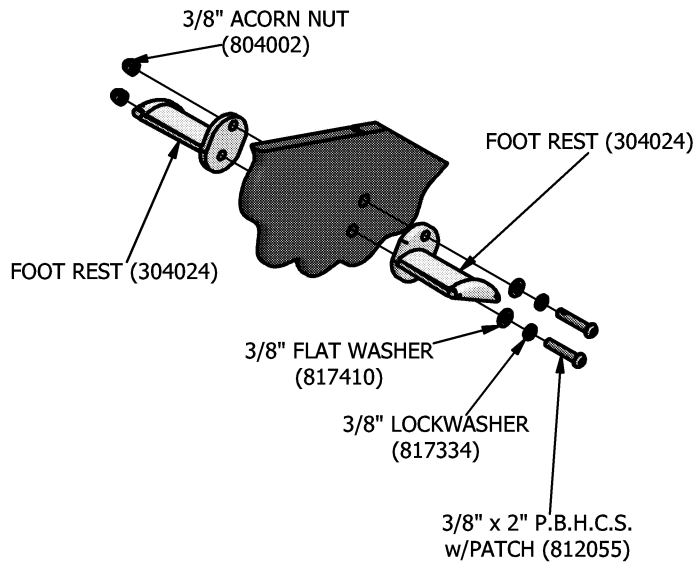

DETAIL A

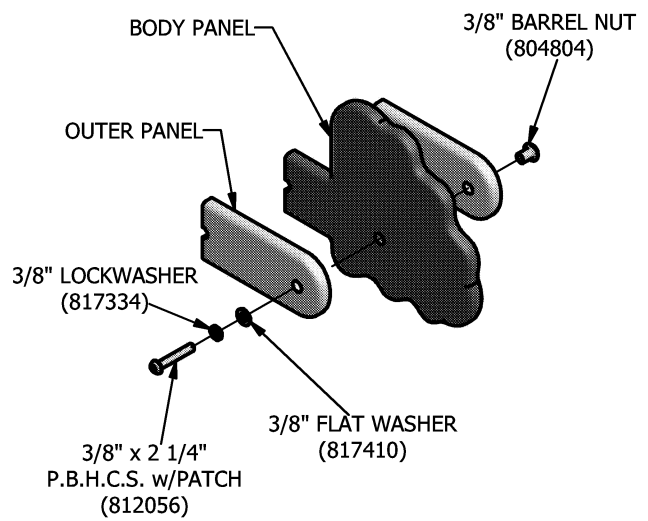

DETAIL B

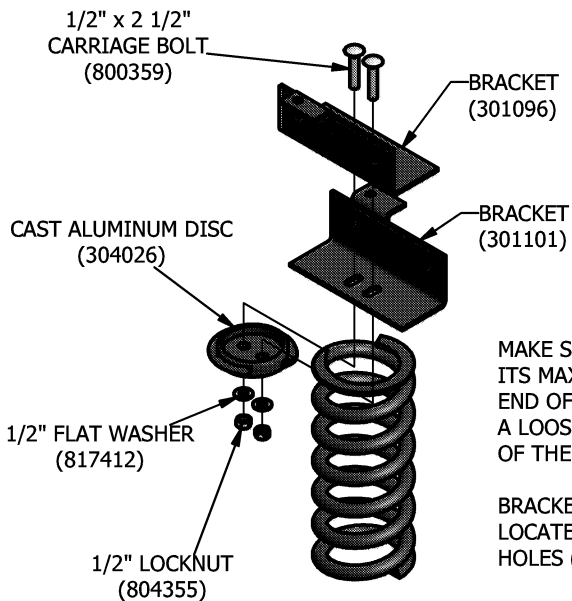

DETAIL C

MAKE SURE CAST DISC IS ROTATED TO ITS MAXIMUM POSITION TOWARDS THE END OF THE SPRING AND SEATED SNUGLY. A LOOSE CASTING MAY CAUSE LOOSENING OF THE SPRING OR BREAKAGE.

BRACKET WITH SLOTS (301101) MUST BE LOCATED BELOW BRACKET WITH SQUARE HOLES (301096).

PLACE FILLER PANELS ON EACH SIDE OF BODY/OUTER PANEL ASSEMBLY AND BOLT BETWEEN BOUNCER BRACKETS USING HARDWARE SHOWN.

DO NOT ATTACH PLASTIC CAPS UNTIL ENTIRE ASSEMBLY IS COMPLETE AND SATISFACTORY. DO NOT FULLY TIGHTEN FASTENERS UNTIL READY TO SNAP IN PLASTIC CAPS.

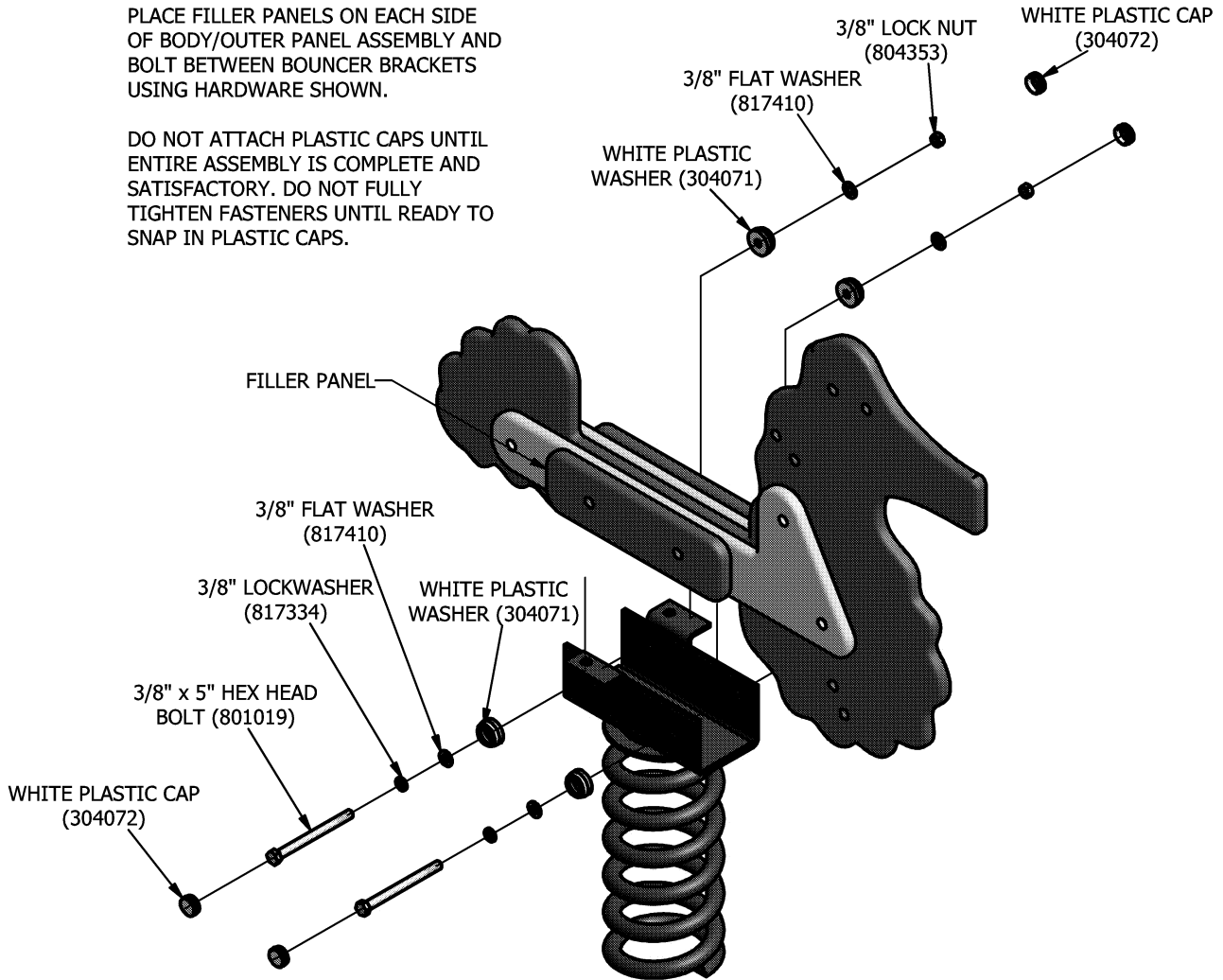

DETAIL D

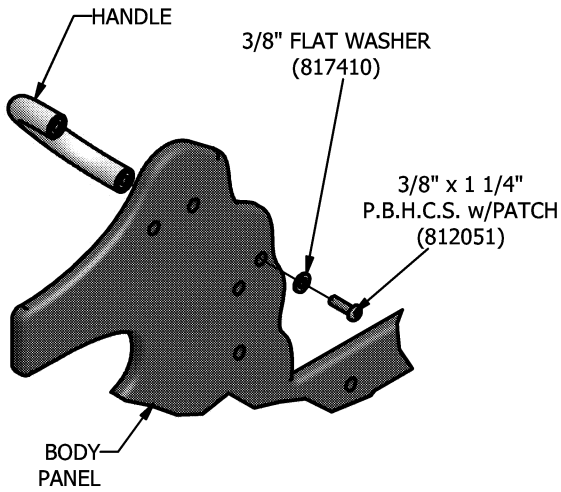

DETAIL E

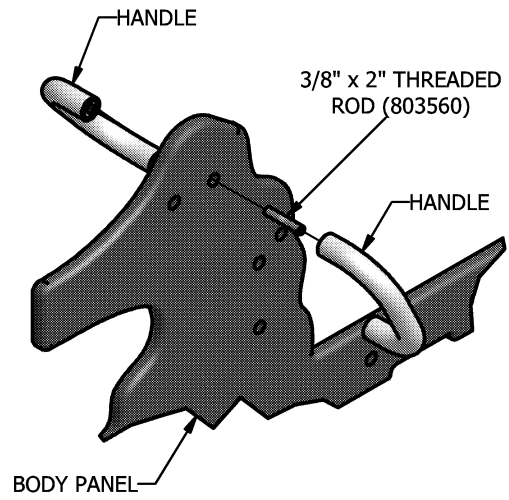

DETAIL F

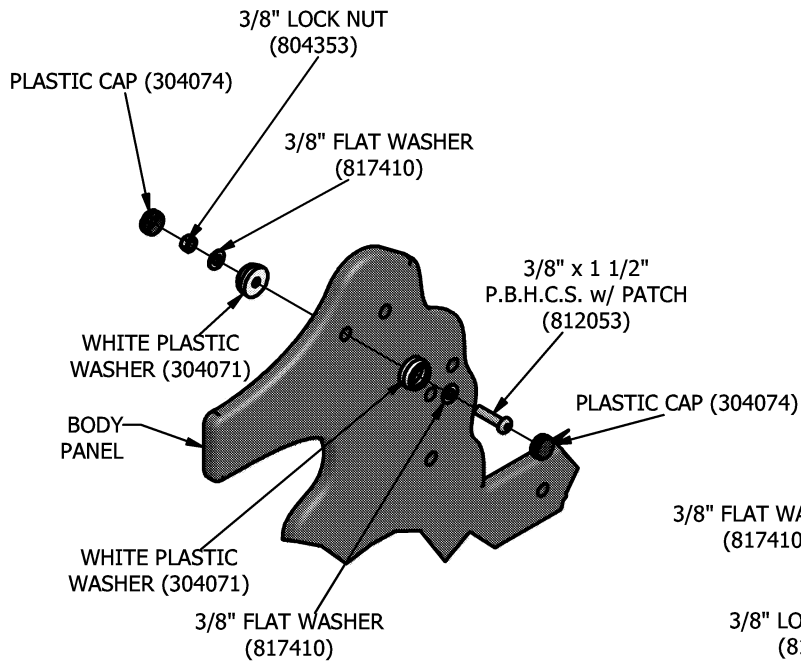

DETAIL G

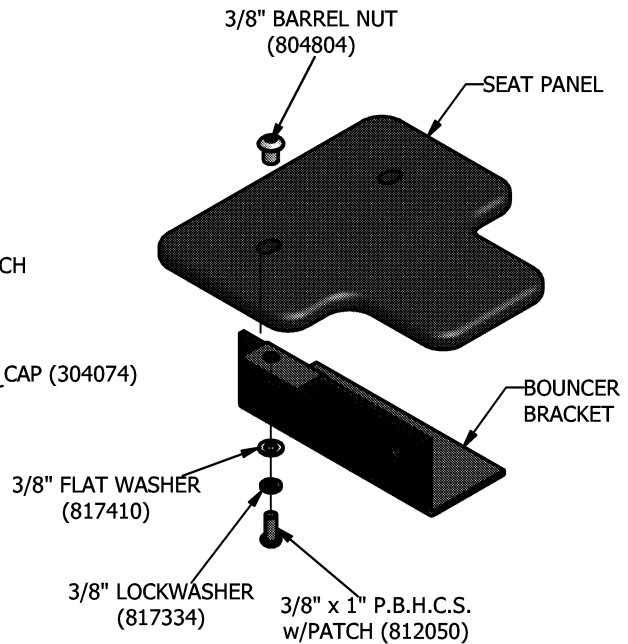

DETAIL H

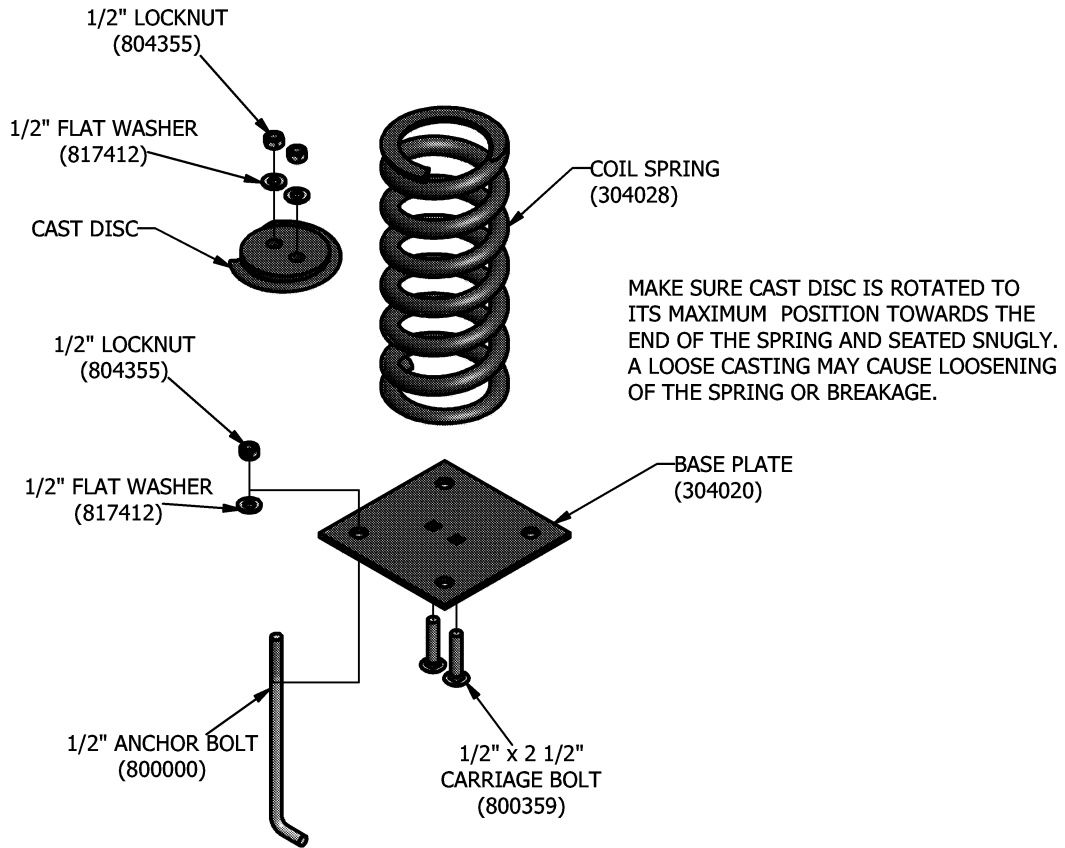

DETAIL I