

EC-625 MOVING TUNNEL

Parts List			
ITEM	DESCRIPTION	QTY	PART NUMBER
1	TIRE	6	402320
2	2' STRAIGHT BIGTUBE w/TWO OVERLAPS	1	401105
3	30 DEG. ELBOW, BIG TUBE	2	401108
4	MOVING TUNNEL CRADLE STRAIGHT	1	401469
5	MOVING TUNNEL CRADLE	2	401470
	----HARDWARE COMPLETE----	1	404639
6	BACKING PLATE	6	401476
	DO-NUT BASE 10MM	18	G030
	DO-NUT CAP 10MM	18	G032
	1/2 x 2 1/4" CARRIAGE BOLT	24	800429
	1/2" x 1 1/2" CARRIAGE BOLT	24	800430
	1/2" LOCK NUT	24	804355
	1/2" HEX NUT	2	804055
	1/2" FLAT WASHER	24	817412
	3/8" LOCK NUT	18	804353
	3/8" x 1" P.B.H.C.S. w/PATCH	18	812050
	LABEL PKG, 2-5	1	E401E

Unless Otherwise Specified, All Units of Measure are Each

Items listed below Hardware Complete line are included with Hardware Complete Number

Warning: During Installation, Hardware And Small Parts Are Choking Hazards For Young Children. Store Unused Parts Appropriately Until Assembly Is Completed. Once Assembly Is Completed, Remove Any Unused Parts From The Play Environment And Dispose/Save Them In A Secure Location. Any bolt end protruding more than two full threads beyond the face of the nut causes risk of clothing entanglement. Promptly cut-off flush, file smooth, and treat to prevent corrosion.

Note: Peen Tee-Nuts and Flatwashers to match radius of pipe after assembly is complete.

Note: Loctite (supplied by others) should be used on any non-patch hardware.

INSTALLATION INSTRUCTIONS:

1. Dig Footing Hole as shown in Elevation View.
2. Attach Tunnel Cradle to Tires until flush using Backing Plate, 1/2" Carriage Bolts, 1/2" Lockwashers, and 1/2" Locknuts. See Detail "A".
Note: Since the thickness of the tire varies, use either 2 1/4" Long or 1 1/2" Long Carriage Bolts and 1/2" Hex Nut (non locking) to test fit the connection. Replace Hex Nut with Locking Hex Nut for final connection. Use extra Washers or trim bolt end if necessary to ensure that no more than two threads extend beyond the face of the nut.
3. Attach Tube to Cradle using Do-Nut Cap, 3/8" Hex Nut, Do-Nut Base, and 3/8" x 1" P.B.H.C.S. w/ Patch. See Detail "B".

MAINTENANCE PROCEDURE:

Periodically check hardware for tightness, and tighten as necessary. Always check all parts for breakage or wear, and immediately put equipment out of service until any faulty parts found are repaired or replaced. Also Check all metal parts for rust, paint loss and touch-up if necessary with paint. Check for welded areas and verify integrity. Check periodically resilient surfacing for appropriate depth and remove extraneous materials that could cause injury, infection, or disease. Maintain detailed installation, inspection, maintenance, and repair records for each public-use playground equipment.

EC-625 MOVING TUNNEL

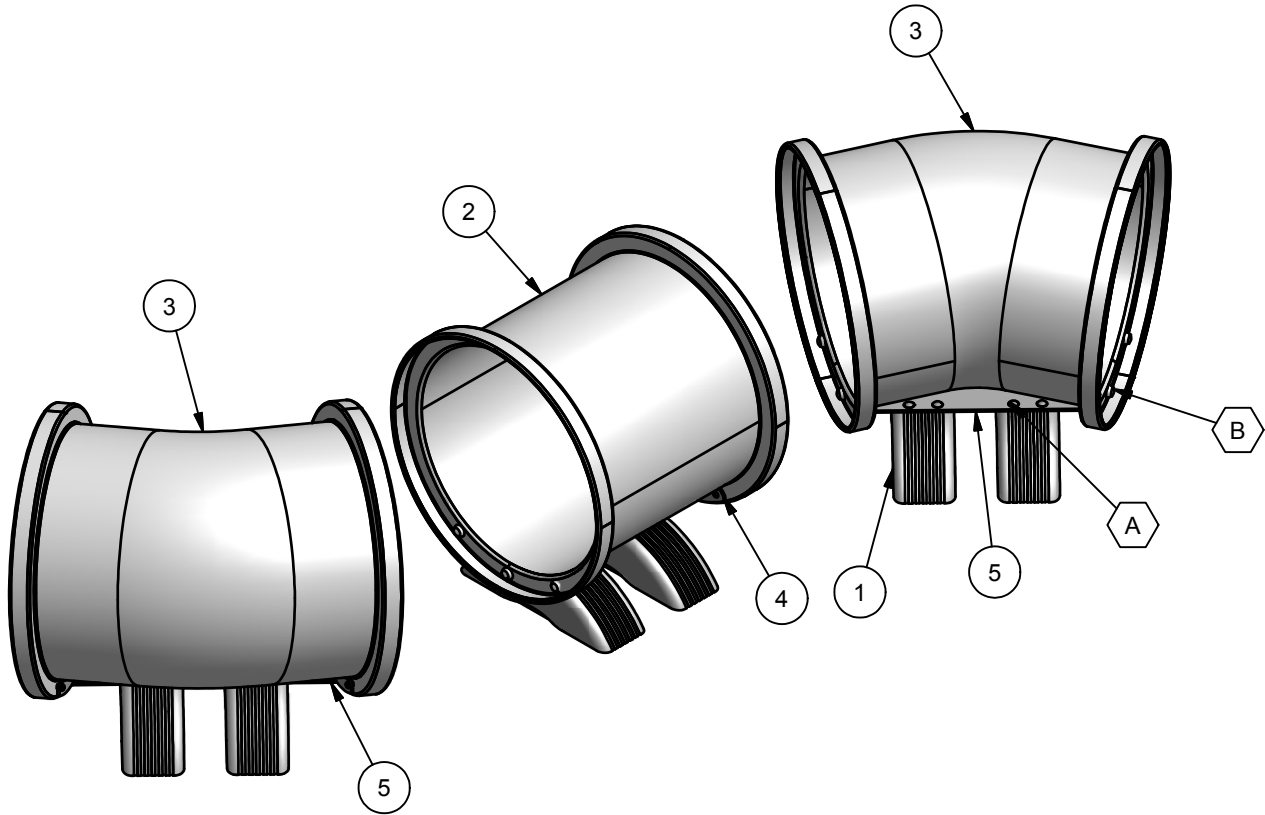

FINISHED ASSEMBLY

EC-625 MOVING TUNNEL

CONCRETE REQUIRED

22 CUBIC YARDS
.17 [CUBIC METERS]

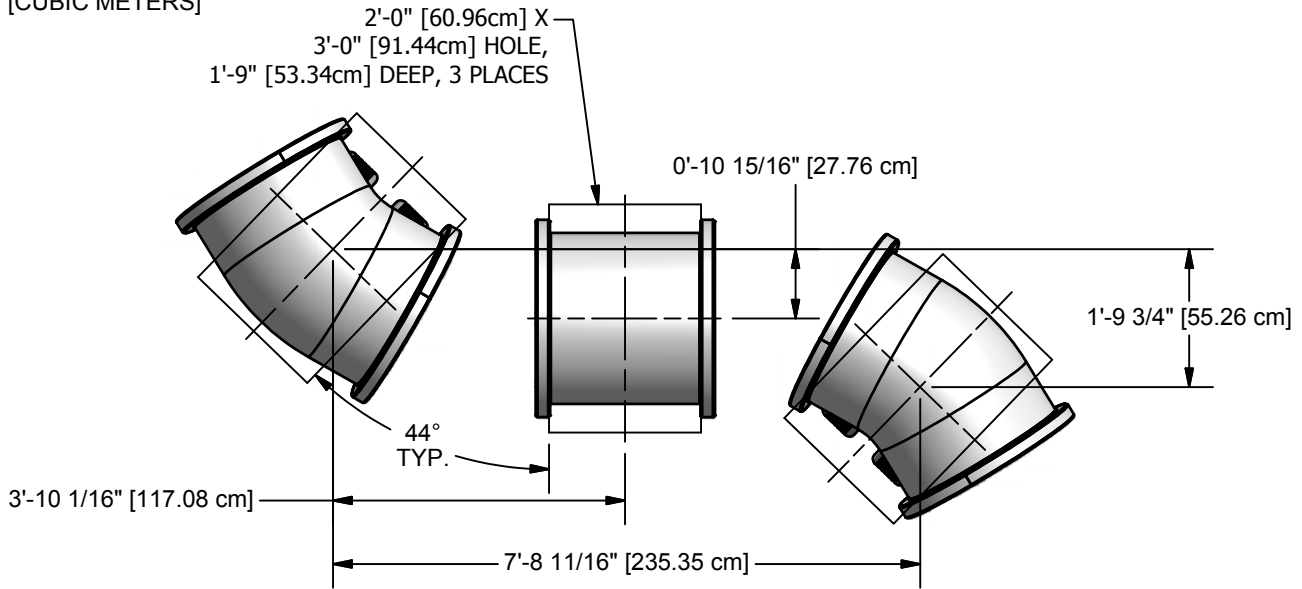

TOP VIEW

NOTE: HOLE DEPTHS INDICATED ON ALL GROUND PLANS ARE MEASURED FROM THE FINISHED SURFACE. ALL FOOTING DIMENSIONS ARE BASED ON A LEVEL FINISHED SURFACE.

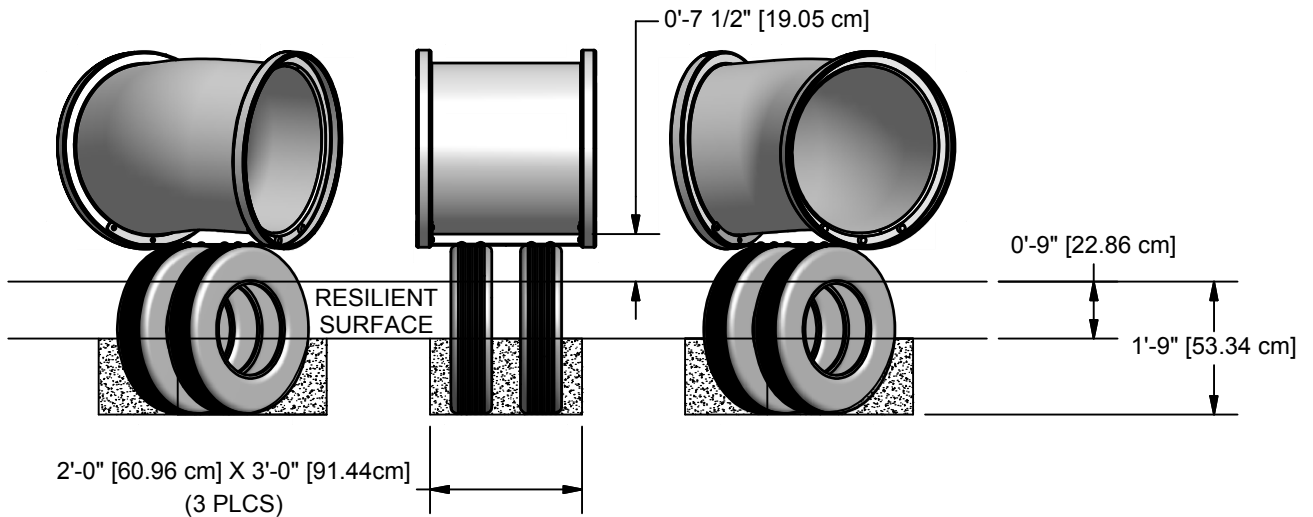

ELEVATION VIEW

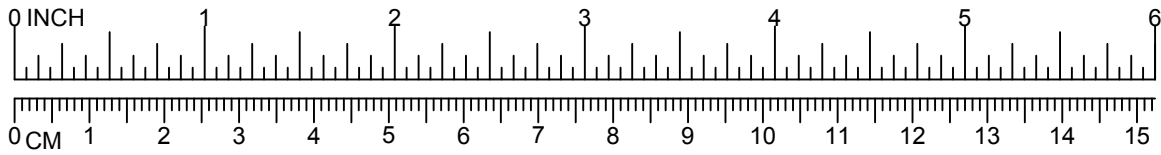

EC-625 MOVING TUNNEL

